

#401 - 245 ST DAVIDS AVENUE, NORTH VANCOUVER

TOTALS
Main Floor*: 760 sq.ft.

OTHER AREAS:
Balcony: 61 sq.ft.

* Measured to exterior of walls and to the middle of the common walls
* These measurements are not taken from the Strata Plan.

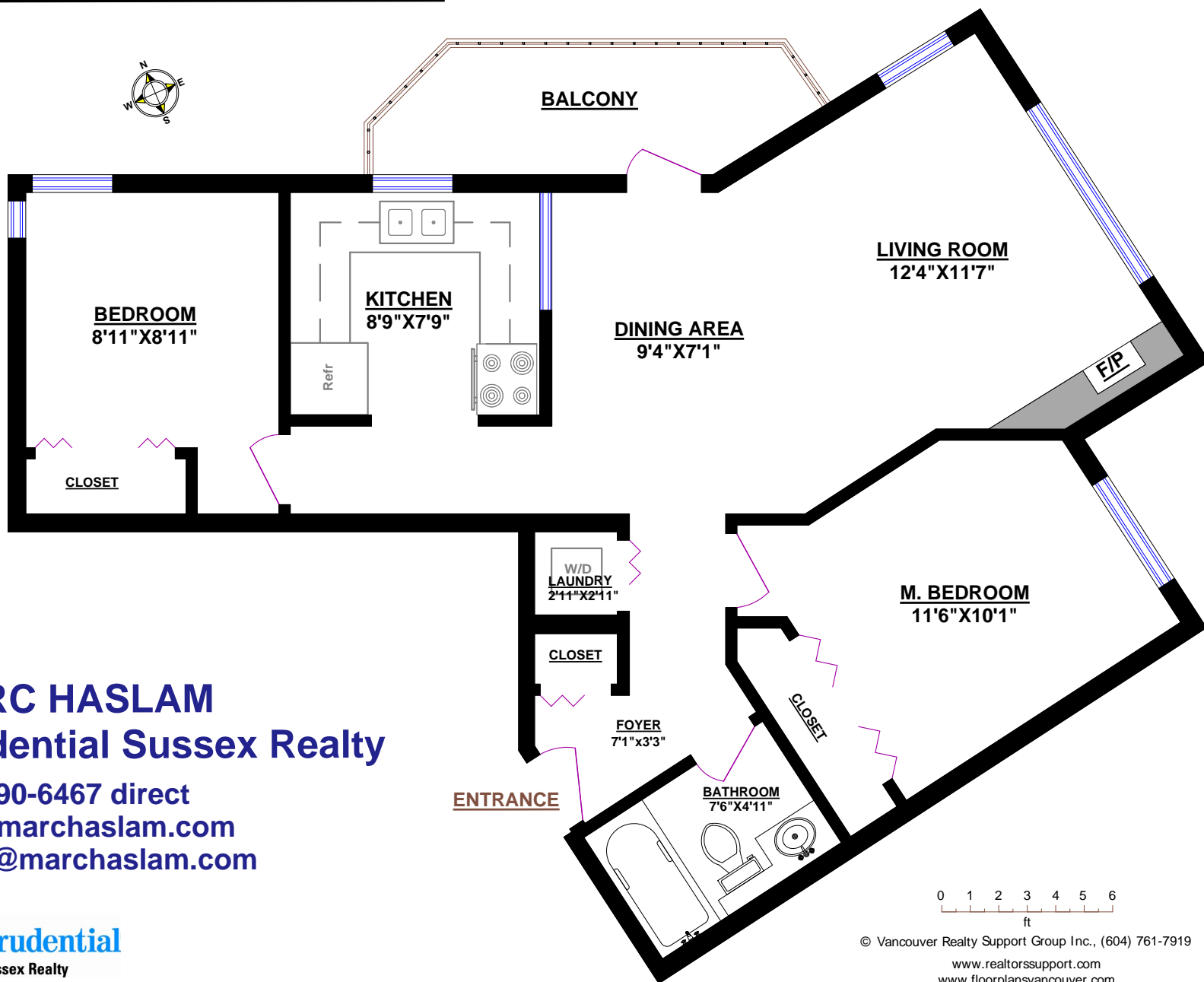

MARC HASLAM
Prudential Sussex Realty

604-990-6467 direct
www.marchaslam.com
marc@marchaslam.com

