

**TERI STEELE**  
604 897-2010  
teri@teristeele.com

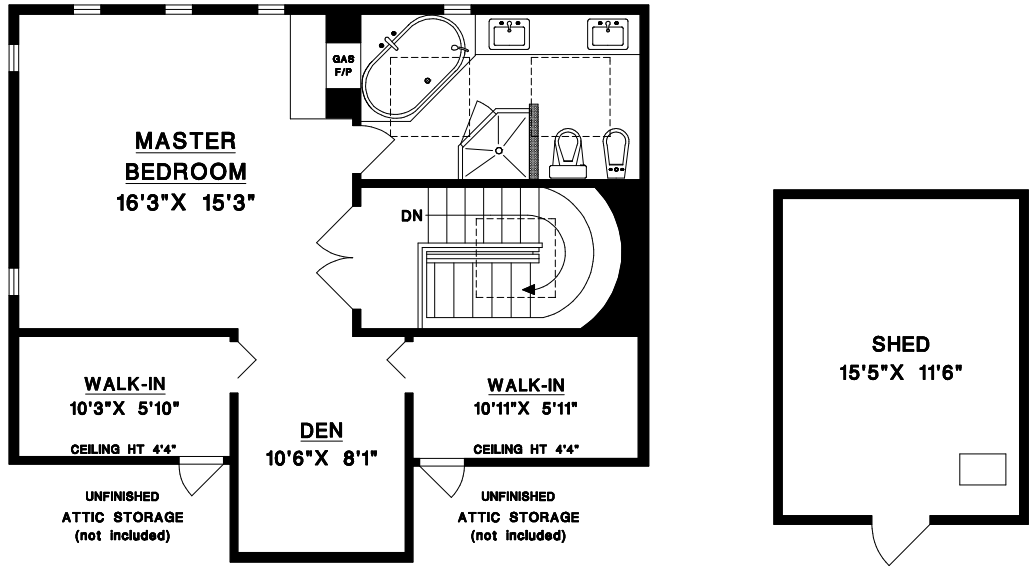

4563 - 46A STREET  
LADNER, BC

MAIN LEVEL	1363	SQFT
UPPER LEVEL *	737	SQFT
<b>TOTAL</b>	<b>2100</b>	<b>SQFT</b>

GARAGE	232	SQFT
SHED	201	SQFT
DECK (& STAIRS)	404	SQFT

\* INCLUDES AREAS OF LOWER CEILING HEIGHT

